

**NOTICE!!**

**These documents have been scanned!**

**Do not place un-scanned documents beneath this notice!**

**Do not remove this notice from this file!**

GPO Jacket No. 560-102  
Print Order 61540  
Rise Business Services, LLC  
Job=AZ15 4/30/2019



Box Number= AZ15011



Claim Begin-End: AMC441664-AMC441664

1 Initial Receipt



AZ15011-19

AMC450400-AMC453366

**AMC #****DATE CLOSED****ADJ INITIAL**

REMARKS

[illegible]



United States Department of the Interior  
Bureau of Land Management  
DIV OF LANDS, MINRLS & ENERGY  
ONE N CENTRAL AVE  
PHOENIX, AZ 85004 -4427  
Phone: 602-417-9200

Receipt

No: 3760675

<b>Transaction #:</b> 3866620	
<b>Date of Transaction:</b> 02/10/2017	
CUSTOMER:	
	SILVER NICKEL MINING CO 5822 W MICHELLE DR GLENDALE, AZ 85308-1244 US

**ENTERED**  
FEB 14 2017  
BY: *Ryan*

LINE #	QTY	DESCRIPTION	REMARKS	UNIT PRICE	TOTAL
1	1.00	LOCATABLE MINERALS / MINING CLAIMS-NEW, UNADJUD, ONE OR MORE AUTH NOS / NEW MINING CLAIM PROCESSING FEE <b>CASES:</b> AMC441664/\$20.00		- n/a -	20.00
2	1.00	LOCATABLE MINERALS / MINING CLAIMS-NEW, UNADJUD, ONE OR MORE AUTH NOS / NEW MINING CLAIMS LOCATION FEE <b>CASES:</b> AMC441664/\$37.00		- n/a -	37.00
3	1.00	LOCATABLE MINERALS / MINING CLAIMS-NEW, UNADJUD, ONE OR MORE AUTH NOS / NEW MINING CLAIMS MAINTENANCE FEE <b>CASES:</b> AMC441664/\$155.00		- n/a -	155.00
<b>TOTAL:</b>					<b>\$212.00</b>

PAYMENT INFORMATION			
1	AMOUNT:	212.00	POSTMARKED: 02/08/2017
	TYPE:	CHECK	RECEIVED: 02/09/2017
	CHECK NO:	1148	
	NAME:	SILVER NICKEL MINING COMPANY 2222 W CLEARVIEW TRL ANTHEM AZ 85086 US	

REMARKS

This receipt was generated by the automated BLM Collections and Billing System and is a paper representation of a portion of the official electronic record contained therein.



**NOTICE!!**

**These documents have been scanned!**

**Do not place un-scanned documents beneath this notice!**

**Do not remove this notice from this file!**

GPO Jacket No. 560-102  
Print Order 61540  
Rise Business Services, LLC  
Job=AZ15 4/30/2019



Box Number= AZ15011



Claim Begin-End: AMC441664-AMC441664

2 Correspondence



AZ15011-19

AMC450400-AMC453366



**NO  
DOCUMENTS  
FOUND**

NO DOCUMENTS FOUND  
NO DOCUMENTS FOUND



**NOTICE!!**

**These documents have been scanned!**

**Do not place un-scanned documents beneath this notice!**

**Do not remove this notice from this file!**

GPO Jacket No. 560-102  
Print Order 61540  
Rise Business Services, LLC  
Job=AZ15 4/30/2019



Box Number= AZ15011



Claim Begin-End: AMC441664-AMC441664

3 Transfers



AZ15011-19

AMC450400-AMC453366



**NO  
DOCUMENTS  
FOUND**

NO DOCUMENTS FOUND  
NO DOCUMENTS FOUND



**NOTICE!!**

**These documents have been scanned!**

**Do not place un-scanned documents beneath this notice!**

**Do not remove this notice from this file!**

GPO Jacket No. 560-102  
Print Order 61540  
Rise Business Services, LLC  
Job=AZ15 4/30/2019



Box Number= AZ15011



Claim Begin-End: AMC441664-AMC441664

4 Annual Filings



AZ15011-19

AMC450400-AMC453366



DEPARTMENT OF THE INTERIOR  
BUREAU OF LAND MANAGEMENT  
MINING CLAIMS

Run Date/Time: 8/20/2018

MC Maintenance Fees Paid Through the BLM Pay Portal  
(by Date Paid)

Page 119 Of 316

**CBS Receipt: 4232593**

Printed For Lead File # **AMC441664**

Agency Tracking ID: 1533947947

Assessment Year: 2019

Paid On: 8/11/2018

Number of BLM Serial Nr: 62

Total Amount Paid: \$9,610.00

Claim Name	BLM Serial No	Lead File No	Amount Paid
JUNCTION	AMC386588	AMC386588	\$155.00
UNION	AMC386590	AMC386588	\$155.00
GENERAL NO 149	AMC386592	AMC386592	\$155.00
RARE METALS #2	AMC399138	AMC399138	\$155.00
TWIN PEAKS #1	AMC401583	AMC401577	\$155.00
TWIN PEAKS #2	AMC401584	AMC401577	\$155.00
TWIN PEAKS #3	AMC401585	AMC401577	\$155.00
NORIEGA	AMC401586	AMC401577	\$155.00
BLACK WARRIOR #1	AMC406423	AMC406423	\$155.00
BLACK WARRIOR #4	AMC406426	AMC406423	\$155.00
TWIN PEAKS #7	AMC407554	AMC407551	\$155.00
GROWLER LODGE	AMC413502	AMC413502	\$155.00
TROY RANCH 1	AMC421117	AMC421117	\$155.00
TROY RANCH	AMC421118	AMC421117	\$155.00
TROY 16	AMC422940	AMC422940	\$155.00
TROY 17	AMC422941	AMC422940	\$155.00
TROY 18	AMC422942	AMC422940	\$155.00
TROY 19	AMC422943	AMC422940	\$155.00
TROY 20	AMC422944	AMC422940	\$155.00
TROY 21	AMC422945	AMC422940	\$155.00
TROY 22	AMC422946	AMC422940	\$155.00
TROY 32A	AMC422947	AMC422940	\$155.00
TROY 35	AMC423024	AMC423024	\$155.00
TROY 36	AMC423025	AMC423024	\$155.00

NO WARRANTY IS MADE BY BLM FOR USE OF THE DATA FOR PURPOSES NOT INTENDED BY BLM



**DEPARTMENT OF THE INTERIOR  
BUREAU OF LAND MANAGEMENT  
MINING CLAIMS**

Run Date/Time: 8/20/2018

**MC Maintenance Fees Paid Through the BLM Pay Portal  
(by Date Paid)**

Page 120 Of 316

TROY 37	AMC423026	AMC423024	\$155.00
TROY 38	AMC423027	AMC423024	\$155.00
TROY 39	AMC423028	AMC423024	\$155.00
TROY 40	AMC423029	AMC423024	\$155.00
BLACK WARRIOR EXT	AMC425060	AMC425060	\$155.00
CRITIC NO 1	AMC426096	AMC426096	\$155.00
CRITIC NO 2	AMC426097	AMC426096	\$155.00
COPPER HILLS	AMC426240	AMC426240	\$155.00
SAVOY 1	AMC429544	AMC429544	\$155.00
SAVOY 2	AMC429545	AMC429544	\$155.00
SAVOY 14	AMC429628	AMC429628	\$155.00
SAVOY 15	AMC429629	AMC429628	\$155.00
SAVOY 16	AMC429630	AMC429628	\$155.00
SAVOY 17	AMC429631	AMC429628	\$155.00
SAVOY 18	AMC429632	AMC429628	\$155.00
SILVER BONANZA	AMC433778	AMC433778	\$155.00
SILVER RIDGE	AMC434006	AMC434006	\$155.00
SILVER RIDGE NO 1	AMC434007	AMC434006	\$155.00
SILVER RIDGE NO 2	AMC434008	AMC434006	\$155.00
NORTH TIGER NO 1	AMC438557	AMC438557	\$155.00
STANDARD-BULL RUN	AMC438785	AMC438785	\$155.00
BENTON GEN NO 16	AMC441664	AMC441664	\$155.00
GREY EAGLE EXT SOUTH	AMC448614	AMC448614	\$155.00
PF 18	AMC448714	AMC448714	\$155.00
PF 19	AMC448715	AMC448714	\$155.00
PF 20	AMC448716	AMC448714	\$155.00
PF 21	AMC448717	AMC448714	\$155.00
PF 22	AMC448718	AMC448714	\$155.00
PF 28	AMC448719	AMC448714	\$155.00
PF 29	AMC448720	AMC448714	\$155.00
PF 30	AMC448721	AMC448714	\$155.00
OUTPOST 33	AMC449379	AMC449379	\$155.00
OUTPOST 34	AMC449380	AMC449379	\$155.00
OUTPOST 42	AMC449381	AMC449379	\$155.00
OUTPOST 43	AMC449382	AMC449379	\$155.00

NO WARRANTY IS MADE BY BLM FOR USE OF THE DATA FOR PURPOSES NOT INTENDED BY BLM

**DEPARTMENT OF THE INTERIOR  
BUREAU OF LAND MANAGEMENT  
MINING CLAIMS**

**Run Date/Time:** 8/20/2018

**MC Maintenance Fees Paid Through the BLM Pay Portal  
(by Date Paid)**

Page 121 Of 316

OUTPOST 53	AMC449383	AMC449379	\$155.00
OUTPOST 54	AMC449384	AMC449379	\$155.00
RIDGETOP LODE	AMC450151	AMC450151	\$155.00



**United States Department of the Interior****Bureau of Land Management**

BUSINESS &amp; SUPPORT SVCS DIV

ONE N CENTRAL AVE SUITE 800

PHOENIX, AZ 85004 -4427

Phone: 602-417-9200

Receipt

No:

4232593

**Transaction #:** 4347904**Date of Transaction:** 08/10/2018**CUSTOMER:**

F N HAWKINS

2222 W CLEA W RVIEW TRAIL

ANTHEM, AZ 85086 US

LINE #	QTY	DESCRIPTION	REMARKS	UNIT PRICE	TOTAL
1	1.00	LOCATABLE MINERALS / MINING CLAIMS- NOT NEW-UNADJUD, ONE AUTH NO. ONLY / MINING CLAIM MONEY RECEIVED <b>CASES: AMC386588/\$9610.00</b>		- n/a -	9610.00
<b>TOTAL:</b>					<b>\$9,610.00</b>

**PAYMENT INFORMATION**

NOTE: Items will appear on credit card statement as "BLM O Mining Claim".

1	AMOUNT:	9610.00	POSTMARKED:	N/A
	TYPE:	CREDIT CARD	RECEIVED:	08/10/2018
	NAME:	F N HAWKINS 2222 W CLEA W RVIEW TRAIL ANTHEM AZ 85086 US		
	CARD NO:	XXXXXXXXXXXX0411	AUTH CODE:	01050P
	NAME ON CARD:	F N HAWKINS		
	SIGNATURE:			

**REMARKS**

This receipt was generated by the automated BLM Collections and Billing System and is a paper representation of a portion of the official electronic record contained therein.

Run Date: 08/21/17

Run Time: 09:47 AM

**DEPARTMENT OF THE INTERIOR  
BUREAU OF LAND MANAGEMENT  
MINING CLAIMS**

**MC Maintenance Fees Paid Through the BLM Pay Portal**

**CBS Receipt: 3936708**

Printed For Lead File # **AMC441664**

Agency Tracking ID: 1502758248

Assessment Year: 2018

Number of BLM Serial Nr: 46

Paid On: 08/14/2017

Total Amount Paid: \$7,130.00

Claim Name	BLM Serial No	Lead File No	Amount Paid
JUNCTION	AMC386588	AMC386588	\$155.00
UNION	AMC386590	AMC386588	\$155.00
GENERAL NO 149	AMC386592	AMC386592	\$155.00
RARE METALS #2	AMC399138	AMC399138	\$155.00
TWIN PEAKS #1	AMC401583	AMC401577	\$155.00
TWIN PEAKS #2	AMC401584	AMC401577	\$155.00
TWIN PEAKS #3	AMC401585	AMC401577	\$155.00
NORIEGA	AMC401586	AMC401577	\$155.00
BLACK WARRIOR #1	AMC406423	AMC406423	\$155.00
BLACK WARRIOR #4	AMC406426	AMC406423	\$155.00
TWIN PEAKS #7	AMC407554	AMC407551	\$155.00
TROY RANCH 1	AMC421117	AMC421117	\$155.00
TROY RANCH	AMC421118	AMC421117	\$155.00
TROY 16	AMC422940	AMC422940	\$155.00
TROY 17	AMC422941	AMC422940	\$155.00
TROY 18	AMC422942	AMC422940	\$155.00
TROY 19	AMC422943	AMC422940	\$155.00
TROY 20	AMC422944	AMC422940	\$155.00
TROY 21	AMC422945	AMC422940	\$155.00
TROY 22	AMC422946	AMC422940	\$155.00
TROY 32A	AMC422947	AMC422940	\$155.00
TROY 35	AMC423024	AMC423024	\$155.00
TROY 36	AMC423025	AMC423024	\$155.00
TROY 37	AMC423026	AMC423024	\$155.00
TROY 38	AMC423027	AMC423024	\$155.00
TROY 39	AMC423028	AMC423024	\$155.00
TROY 40	AMC423029	AMC423024	\$155.00
BLACK WARRIOR EXT	AMC425060	AMC425060	\$155.00
CRITIC NO 1	AMC426096	AMC426096	\$155.00
CRITIC NO 2	AMC426097	AMC426096	\$155.00
COPPER HILLS	AMC426240	AMC426240	\$155.00
SILVER BONANZA	AMC433778	AMC433778	\$155.00
SILVER RIDGE	AMC434006	AMC434006	\$155.00
SILVER RIDGE NO 1	AMC434007	AMC434006	\$155.00
SILVER RIDGE NO 2	AMC434008	AMC434006	\$155.00
NORTH TIGER NO 1	AMC438557	AMC438557	\$155.00

**NO WARRANTY IS MADE BY BLM FOR USE OF THE DATA FOR PURPOSES NOT INTENDED BY BLM**



Run Date: 08/21/17

Run Time: 09:47 AM

**DEPARTMENT OF THE INTERIOR  
BUREAU OF LAND MANAGEMENT  
MINING CLAIMS**

**MC Maintenance Fees Paid Through the BLM Pay Portal**

**CBS Receipt: 3936708**

Printed For Lead File # AMC441664

Agency Tracking ID: 1502758248

Assessment Year: 2018

Number of BLM Serial Nr: 46

Paid On: 08/14/2017

Total Amount Paid: \$7,130.00

<b>Claim Name</b>	<b>BLM Serial No</b>	<b>Lead File No</b>	<b>Amount Paid</b>
STANDARD-BULL RUN	AMC438785	AMC438785	\$155.00
COLUMBUS	AMC440212	AMC440212	\$155.00
SUE	AMC440267	AMC440267	\$155.00
NORTH COLOSSAL	AMC440420	AMC440420	\$155.00
COMPENSATION NO 2	AMC441152	AMC441152	\$155.00
BOSTON	AMC441241	AMC441241	\$155.00
CLEVELAND	AMC441242	AMC441241	\$155.00
COMPENSATION #3	AMC441243	AMC441241	\$155.00
COMPENSATION #4	AMC441244	AMC441241	\$155.00
BENTON GEN NO 16	AMC441664	AMC441664	\$155.00

## United States Department of the Interior

## Bureau of Land Management

BUSINESS &amp; SUPPORT SVCS DIV

ONE N CENTRAL AVE SUITE 800

PHOENIX, AZ 85004 -4427

Phone: 602-417-9200

Receipt

No: 3936708

<b>Transaction #:</b> 4046332	
<b>Date of Transaction:</b> 08/14/2017	
CUSTOMER:	
	F N HAWKINS 2222 W. CLEARVIEW TRAIL ANTHEM, AZ 85086 US

LINE #	QTY	DESCRIPTION	REMARKS	UNIT PRICE	TOTAL
1	1.00	LOCATABLE MINERALS / MINING CLAIMS- NOT NEW-UNADJUD, ONE AUTH NO. ONLY / MINING CLAIM MONEY RECEIVED <b>CASES:</b> AMC434008/\$7130.00		- n/a -	7130.00
<b>TOTAL:</b>					<b>\$7,130.00</b>

PAYMENT INFORMATION			
NOTE: Items will appear on credit card statement as "BLM O Mining Claim".			
1	AMOUNT:	7130.00	POSTMARKED: N/A
	TYPE:	CREDIT CARD	RECEIVED: 08/14/2017
	NAME:	F N HAWKINS 2222 W. CLEARVIEW TRAIL ANTHEM AZ 85086 US	
	CARD NO:	XXXXXXXXXXXX0411	AUTH CODE: 01448P
	NAME ON CARD:	F N HAWKINS	
	EXPIRES:	05/2020	
	SIGNATURE:		

REMARKS

This receipt was generated by the automated BLM Collections and Billing System and is a paper representation of a portion of the official electronic record contained therein.



**NOTICE!!**

**These documents have been scanned!**

**Do not place un-scanned documents beneath this notice!**

**Do not remove this notice from this file!**

GPO Jacket No. 560-102  
Print Order 61540  
Rise Business Services, LLC  
Job=AZ15 4/30/2019



Box Number= AZ15011



Claim Begin-End: AMC441664-AMC441664

5 Miscellaneous



AZ15011-19

AMC450400-AMC453366

**NO  
DOCUMENTS  
FOUND**

NO DOCUMENTS FOUND  
NO DOCUMENTS FOUND



**NOTICE!!**

**These documents have been scanned!**

**Do not place un-scanned documents beneath this notice!**

**Do not remove this notice from this file!**

GPO Jacket No. 560-102  
Print Order 61540  
Rise Business Services, LLC  
Job=AZ15 4/30/2019



Box Number= AZ15011



Claim Begin-End: AMC441664-AMC441664

6 Location Notices-Amendments and Supporting Documents



AZ15011-19 AMC450400-AMC453366



# MINING CLAIM STATUS REPORT

Data Entered: 02/14/17 Rm

MTP Checked By: 02/14/17 Rm

GEO Checked By: 02/14/17 Rm

LEAD SERIAL NUMBER: AMC 441664 thru AMC

## NUMBER OF CLAIMS & TYPE:

1 LODE  
PLACER  
ASSOCIATION PLACER  
MILL SITE  
TUNNEL SITE

## CHARGES:

Processing Fee @ \$20 = \$ 20.00  
Location Fee @ \$37 = \$ 37.00  
Maintenance Fee @ \$155 = \$ 155.00  
Add'l Maint Fee for Assoc Placer = \$  
SUBTOTAL \$ 212.00  
Other Fees \$  
Other Fees \$  
TOTAL \$ 212.00

TOTAL ACREAGE: Per Claim  
(Placer Only)

NUMBER OF LOCATORS:

DOCUMENTS RECEIVED VIA : Over-the-Counter [ ] Mail [x] TIMELY FILED: Yes [x] No [ ]

LEGAL DESCRIPTION: T 10N R 1W SEC 22  
T R SEC  
T R SEC  
T R SEC  
T R SEC

BLM [ ] FOREST SERVICE [ ] SUBJ TO PL 359: Yes [ ] No [ ]  
WILDERNESS AREA [ ]

SPLIT ESTATE: N/A [ ] SX [ ] PX [ ] OTHER [ ]  
SRHA [ ] Was proper Notice filed if located on SHRA Land? Yes [ ] No [ ]

## RECONVEYED MINERALS ON BLM LAND REQUIRE OPENING ORDER FROM 1944 TO 1993:

Open to Entry On N/A [ ]

COMMENTS/STATUS: VOID [ ] PARTIALLY VOID [ ] PVT MINERALS [ ] WITHDRAWN LANDS [ ]  
OTHER [ ]

[ ] Claimant acknowledges that portions of the following claim(s) site(s) may be void or voidable.

Printed Name of Claimant Signature of Claimant

\*\*\*\*\*FINAL ADJUDICATION\*\*\*\*\*

DATE 10/24/2017 INITIALS Rm

AMC 441664



**LOCATION NOTICE FOR LOPE MINING CLAIM**

NOTICE IS HEREBY GIVEN that the DISCOVERY LOCATION  
ON The Benton Gen No. 16 lode mining claim has been located  
by Silver Nickel Mining Co. whose current mailing  
address is 5822 W. Michelle Drive  
Glendale, Arizona 85308-1244

BLM  
Date  
Stamp

RECEIVED  
BLM  
PHOENIX, ARIZONA

2017 FEB - 9 P 2: 1

The general course of this claim is South to north and it is situated in YAVAPAI  
County, Arizona. This claim is 1500 feet in length and 200 feet in width. This claim runs  
from the location monument on which this location notice is posted approximately 1 feet in a  
South direction to the South <sup>Center</sup> end line and 1500 feet in a north direction to the  
North end line. This claim is marked by six monuments, one at each corner and one at the center of each  
end line of the claim.

The location monument on which this notice is posted is situated within Section 22, Township 10  
N, Range 1 W, Gila Salt River Base and Meridian, Arizona and this claim encompasses portions  
of the following quarter section (s), section (s), Township (s) and Range (s) NE 1/4, SE 1/4  
Sec 22, T 10N, R 1W Tiger District

Gila Salt River Base and Meridian, Arizona.

The locality of this claim with reference to some natural object or permanent monument and additional information  
(if any) concerning its locality are as follows: The SW. endline corner of The Benton Gen  
No 16 is identical to the NW endline corner of The California  
Gen No 70. This claim is a relocation of the Benton Gen No 16 except

DATED AND POSTED on the ground this 18 day of JANUARY, 2017.

LOCATOR (s) John B Rothermel / agent for Silver Nickel  
Mining Co. John Rothermel

its length is 1500ft.  
not 1600 feet as the  
original survey.

Form MCF100  
Revised July 2005

AMC441664

Bearings of Benton Gen. No. 16

N 8° E 1500'  
S 8° W 1500'  
N 82° W 200'  
S 82° E 200'

sideline  
sideline  
endline  
endline

Original Benton Gen No. 16  
was 1600' x 200'  
Relocation is  
1500' x 200'

# MINING CLAIM MAP

Lode (X) Placer ( )

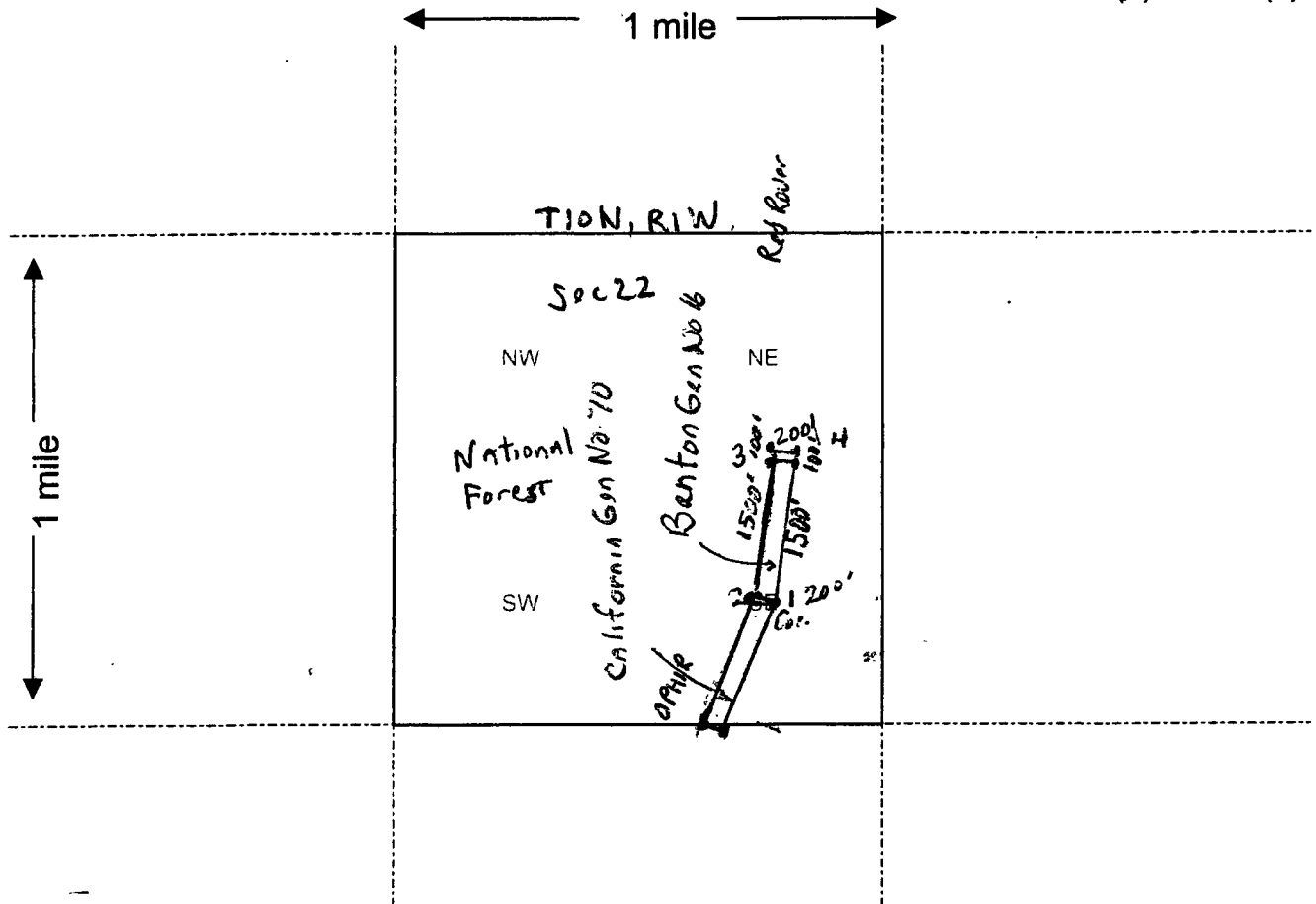

AMC441664

Scale: 1" = 2000 feet  
Disc Loc. on

- The above map depicts the The Benton Gen No. 16 mining claim, which is located in Section (s) 22, Township 10 N, Range 1 W, Gila and Salt River Base and Meridian, YAVAPAI County, Arizona.
- The type of corner and location monuments used are as follows: Wood post set in mound of stone
- The bearings and distances in degrees and feet between claim corners are as depicted on the map.

Form MCF100a  
Revised July 2005

This form is available from the Arizona Department of Mines & Mineral Resources and may be reproduced.



Tiger Dist.

АМС 441664

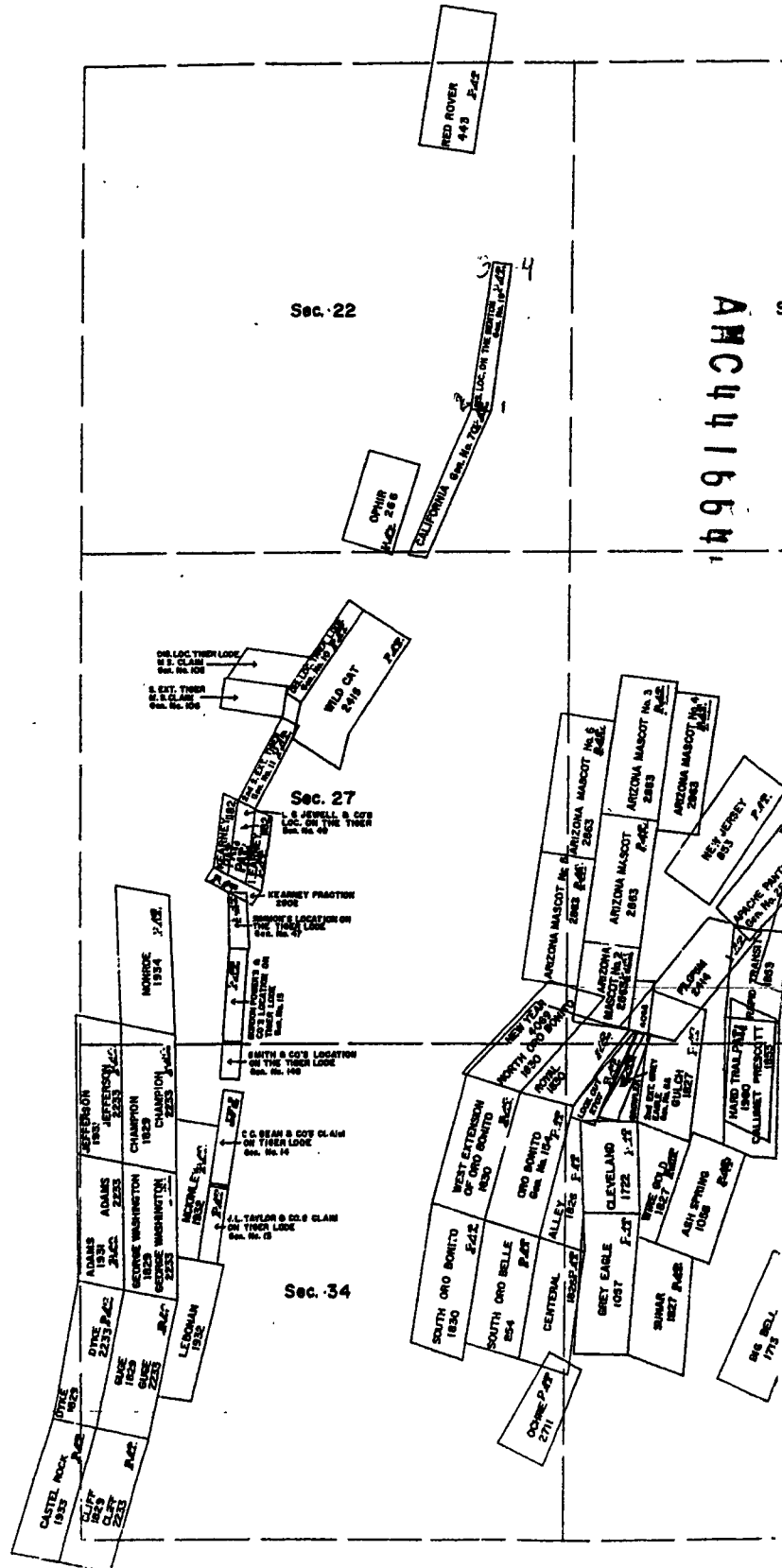

2017 FEB -9 P 2:11

RECEIVED

**DEPARTMENT OF INTERIOR  
BUREAU OF LAND MANAGEMENT**

**Input Parameters for Geographic Report with Land**

**System Id = CR**

**Admin State = AZ**

**Geo State =**

**Casetype Begins With**

**Case Disp Txt = AUTHORIZED, CANCELLED, EXPIRED, PENDING, REJECTED, RELINQUISHED, WITHDRAWN**

**Mer Twp Rng =**

**Section =**

**Mtrs = 14 0100N 0010W 022, 14 0100N 0010W 999**

**Commodity =**

**Commodity Txt =**

**Pending Org =**

**Pend Org Decode =**

**Total Rows Returned: 0**







SILVER NICKEL MINING CO  
2222 W. CLEARVIEW TRAIL  
ANTHEM, AZ 85086

RECEIVED  
BLM AZ STAFF OFFICE

2017 FEB -9 P 2:08

PHOENIX, ARIZONA

PHOENIX AZ 852

08 FEB 2017 PM 5 L



BLM  
One N, Central Ave, St 800  
Phoenix, AZ 85004-4427

85004-442700

